







Laxmi Infra Venture Pvt. Ltd. is an Certified company which is actively engaged in the trade of Real Estate in the state of Odisha. The Company has carved out a niche for itself as a bonafide builder/developer. The Company has already formulated and executed several residential apartments in close proximity of the Capital City and has translated into reality the dream of purchasers to own plots. The Company in its quest to provide self-contained flats/apartments, independent houses, satellite townships has made an integrated planning with emphasis on quality Construction.



Completed Projects

## SPECIFICATION

- Structure : RCC frame structure with pile foundation.
- Brick Work : Fly Ash Bricks.
- Door Frame : Sal wood (5"x2 1/2 " )
- Doors : All internal doors are of company made flush door.
- Main door : Solid teak with Godrej lock.
- Windows : UPVC glazed with 5 mm tinted glass with protective M.S. Grill.
- Walls : Ceramic Wall tiles upto 7' height in all bathrooms.
- Painting : Putty finish with one coat primer and color.  
Weather coat in exterior walls
- Kitchen : Granite slab in cooking platform with stainless steel kitchen sink. 2' height ceramic wall tile.
- Flooring : Vitrified Tiles in all rooms  
Anti skid tiles in all bathrooms.
- Electricals : Fire resistant insulated copper wire/cable in concealed conduits. Switches & Sockets of Modular range. A.C. Points in all Bed Rooms.
- Sanitary Fittings : Hot and cold water provision in all bathrooms and all CP fittings are of Hindware /equivalent company

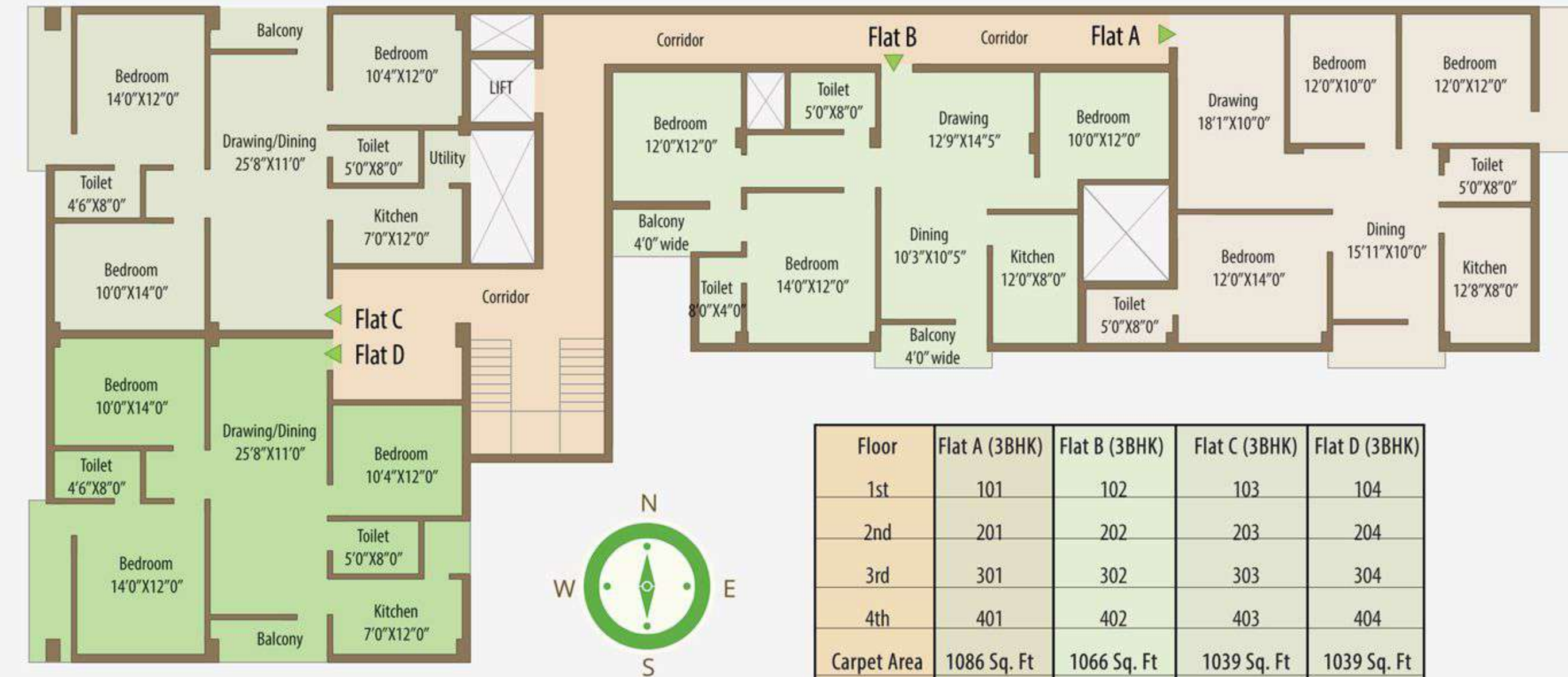

Floor	Flat A (3BHK)	Flat B (3BHK)	Flat C (3BHK)	Flat D (3BHK)
1st	101	102	103	104
2nd	201	202	203	204
3rd	301	302	303	304
4th	401	402	403	404
Carpet Area	1086 Sq. Ft	1066 Sq. Ft	1039 Sq. Ft	1039 Sq. Ft
S.B. Area	1691 Sq. Ft	1686 Sq. Ft	1586 Sq. Ft	1586 Sq. Ft



Flat A  
1086/1691 Sq. Ft



Flat B  
1066/1686 Sq. Ft



Flat C/D  
1039/1586 Sq. Ft



## Facilities

- Standby generator for common utilities like lift, common lights and each flat 250 watt supply.
- Water supply by deep borewell through separate over head reservoirs of adequate capacity.
- Separate transformer for electric supply
- Telephone outlets in each flat
- Cable TV outlet in each flat
- Parking space for two wheelers in the stilt floor.
- 24 Hrs security with CC Camera.
- Security Guard Room
- Community Hall
- Lift



## Payment Schedule

- Booking Amount 5%
- On execution of Agreement & Allotment 15%
- On completion of foundation 10%
- On completion of stilt floor roof slab 10%
- On completion of 1st floor roof slab 10%
- On completion of 2nd floor roof slab 10%
- On completion of 3rd floor roof slab 10%
- On completion of 4th floor roof slab 5%
- Towards completion of brick work and plastering 10%
- Towards completion of flooring and finishing 10%
- Upon completion and Before registration 5%



SITE MAP  
Not to Scale

### LAXMI Bhawan

Capital Hospital	: 1.0 Km
Kalpana	: 0.5 Km
Lingaraj Temple	: 1.0 Km
Rajmahal	: 1.0 Km
Airport	: 1.5 Km



Developers:  
**Laxmi Infra Venture Pvt.Ltd**  
 315, Sahid Nagar, Behind Imfa Park  
 Bhubaneswar - 07, Tel : 0674-2549387  
 Email : [laxmiinfra@gmail.com](mailto:laxmiinfra@gmail.com), [info@laxmiinfra.co.in](mailto:info@laxmiinfra.co.in)  
 Web : [www.laxmiinfra.co.in](http://www.laxmiinfra.co.in)

Architect :



*In the Heart of the Temple City*

